

# TOOLS

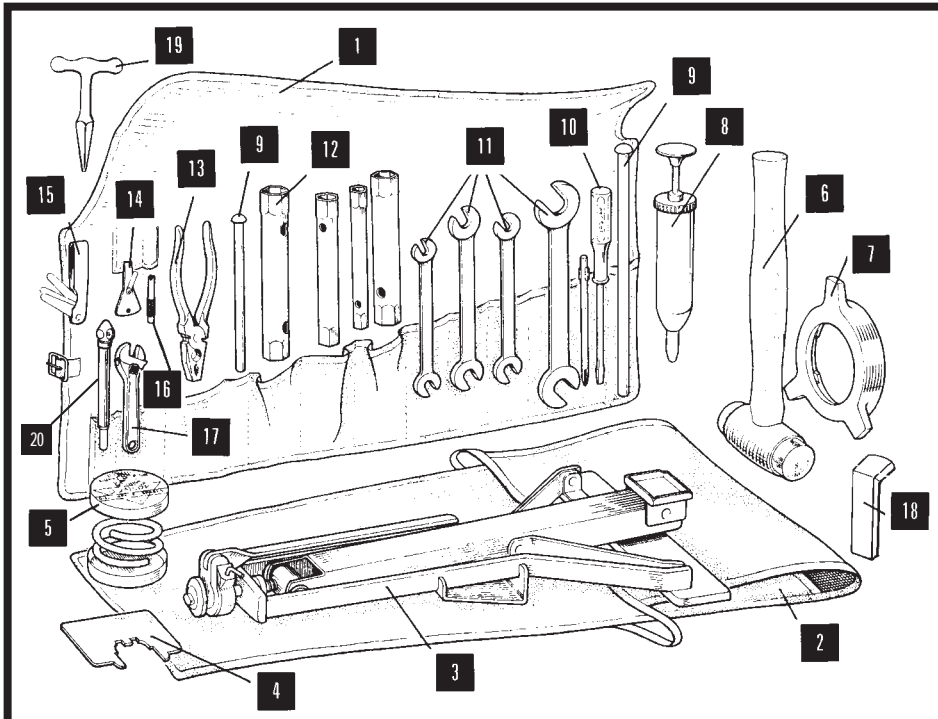

TOOL ROLL <span style="float: right;">Item 1</span>		
MODEL	PART No	QTY PER VEHICLE
XK 120	9630XK (Canvas)	1
XK140-150 AND ALL 'E' TYPE	9632XK	1

JACK BAG <span style="float: right;">Item 2</span>		
MODEL	PART No	QTY PER VEHICLE
MOST MODELS	BD23688	1

JACK <span style="float: right;">Item 3</span>		
MODEL	PART No	QTY PER VEHICLE
XK MODELS	9820XK	1
	9680XK (Handle)	1
V12 'E' TYPE & XJ MODELS	C33924	1
	12870 (Handle)	1

CAM GAUGE <span style="float: right;">Item 4</span>		
MODEL	PART No	QTY PER VEHICLE
MOST MODELS	C3993	1

BLEEDER TIN <span style="float: right;">Item 5</span>		
MODEL	PART No	QTY PER VEHICLE
ALL MODELS	C13620 (Dunlop)	1
	C13620/1 (Girling)	1

HAMMER <span style="float: right;">Item 6</span>		
MODEL	PART No	QTY PER VEHICLE
ALL MODELS	XKE2	1

SPINNER ADAPTOR <span style="float: right;">Item 7</span>		
MODEL	PART No	QTY PER VEHICLE
V12 'E' TYPE*	C28687	1

\* Utilised on earlier models with continental spinners

GREASE GUN <span style="float: right;">Item 8</span>		
MODEL	PART No	QTY PER VEHICLE
XK 140 & EARLY 150	C10176	1
LATE XK150 & 6 CYL 'E' TYPE	C13269	1

TOMMY BAR <span style="float: right;">Item 9</span>		
MODEL	PART No	QTY PER VEHICLE
ALL MODELS	C2896 (Large)	1
	C20825 (Small)	1

SCREWDRIVER <span style="float: right;">Item 10</span>		
MODEL	PART No	QTY PER VEHICLE
XK 140-150 & ALL 'E' TYPE	C20482	1

SPANNERS <span style="float: right;">Item 11</span>		
MODEL	PART No	QTY PER VEHICLE
ALL MODELS	C4594 ( $\frac{3}{4} \times \frac{7}{8}$ )	1
	C4595 ( $\frac{9}{16} \times \frac{5}{8}$ )	1
	C4596 ( $\frac{7}{16} \times \frac{1}{2}$ )	1
	C4638 ( $\frac{11}{32} \times \frac{3}{8}$ )	1

SPARK PLUS SPANNER <span style="float: right;">Item 12</span>		
MODEL	PART No	QTY PER VEHICLE
ALL 6 CYL MODELS	C33607	1
V12 'E' TYPE	C36613	1

PLIERS <span style="float: right;">Item 13</span>		
MODEL	PART No	QTY PER VEHICLE
ALL MODELS	AFU1024	1

POINTS SCREWDRIVER <span style="float: right;">Item 14</span>		
MODEL	PART No	QTY PER VEHICLE
MOST MODELS	C5444	1

FEELER GAUGE <span style="float: right;">Item 15</span>		
MODEL	PART No	QTY PER VEHICLE
MOST MODELS	C5587	1

TYRE VALVE KEY <span style="float: right;">Item 16</span>		
MODEL	PART No	QTY PER VEHICLE
MOST MODELS	C993	1

ADJUSTABLE SPANNER <span style="float: right;">Item 17</span>		
MODEL	PART No	QTY PER VEHICLE
MOST MODELS	C23296*	1

\* Not as original.

HUB CAP WRENCH <span style="float: right;">Item 18</span>		
MODEL	PART No	QTY PER VEHICLE
MOST STEEL WHEEL MODELS	C26864	1

'T' KEY <span style="float: right;">Item 19</span>		
MODEL	PART No	QTY PER VEHICLE
ALL XK MODELS & EARLY 3.8 'E' TYPE	9800XK	1

TYRE PRESSURE GAUGE <span style="float: right;">Item 20</span>		
MODEL	PART No	QTY PER VEHICLE
ALL MODELS	C11753	1

XJ - XJS TOOLS AVAILABLE TO SPECIAL ORDER ONLY

"CHURCHILL" TOOLS ALSO AVAILABLE TO ORDER.